





# No leaks, guaranteed.

With Atlantis you can be sure that leaks from your tiled shower are a thing of the past.

Whatever your bathroom environment and flooring structure, our primary focus is to create a superior shower solution that will make your shower space watertight.

At Atlantis we are so confident in the superior performance of our Linea Quattro™ shower base system and EasyNiche™ tiled shelf system that we will guarantee their durability and leak-free function for a minimum of 25 years\* – exceeding the requirements of the Building Code of Australia, giving you peace of mind that your choice in Atlantis is the right one.

\* See detailed Warranty Statement on Pg. 22.





# The Atlantis Shower Solution



## A. SOLID BASE

The Atlantis shower base is unlike any other. The one-piece waterproof shower base made from durable materials forms a solid shower floor that will not flex or move. All bases can be installed onto existing floors for low-step entry, or can be recessed into the floor structure to create a level-entry shower with minimal alterations required.



## B. 100% WATERPROOF

Made with thermoformed PMMA, backed with a tough fibreglass composite and enclosed with a generously high upstand along each wall-side, the Atlantis shower base is already waterproof and designed for perfect water drainage, leaving no chance for water to escape other than where directed.



## C. SUPERIOR GLAZING CHANNELS

Atlantis glazing channels are designed to interlock at the critical corner junctions, providing a complete water seal and giving you extra peace of mind. **\* The base channel comes factory fitted onto the base**, and the wall channel is applied direct to the waterproofing before tiling to create a superior result.

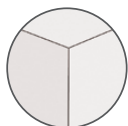

## D. HIGHEST QUALITY SAFETY SCREENS

Whether you prefer a fully-enclosed shower or just to walk in, Atlantis' nano-coated CristalVision™ screens are made to the highest safety standards and are designed to work perfectly with the rest of the shower structure. No separate measuring or waiting required, or reliance on other suppliers. Optional clip-on door seals further enhance water tightness.



## E. EASYNICHE™

Tiled recessed shower shelves can be difficult and time-consuming to construct and waterproof. The Atlantis one-piece EasyNiche™ is made from the same rigid material as the shower base, and can be fitted easily and quickly into the wall for an attractive and fail safe result. Available for tiled or prefinished walls.



## F. 25-YEAR WARRANTY

Because our showers have been rigorously designed and tested from start to finish, we are so confident in the performance of our showers that we promise leak-free showering for the life of your shower. While each system component comes with an individual guarantee, the Atlantis tile-over shower base offers a 25-year durability and leak-free warranty, offering you complete peace of mind.

\*Patent No. 510350. Wall glazing channel Design Registration No. 403850.

# 3 steps to creating your dream shower

## 1 Work out the measurements and ideal shape to fit your space.

Atlantis has a large range of the common shapes and sizes, up to 1800mm wide.

## 2 Select your preferred screen option to match from our range of styles.

Choose from hinged, sliding or walk-in (panel) screen options on all showers.

## 3 Decide on what accessories you would like with your shower.

Accessorise your shower with EasyNiche™ recessed wall shelf and/or footrest (page 14).

## \* Now it's time to choose your tapware, tiles and book your shower installation!

We advise using a qualified tradesperson or shower installer.

To contact a recommended independent installer near you, visit [www.atlantis.com.au](http://www.atlantis.com.au)

Note: Atlantis product warranties apply regardless of who installs the product. See Page 20 for warranty details.

# 5 steps to installing your tiled shower



## Step 1.

Position shower base.



## Step 2.

Apply waterproofing.



## Step 3.

Fit wall glazing channels,  
then lay tiles.



## Step 4.

Tiling complete.



## Step 5.

Fit frameless screens.



Overview of installation method – the above scenario and times are a guide only. Installation times may vary depending on materials used, and may be carried out on more than one day.









# linea quattro

---

The market-leading tile-over  
channel drain shower,  
featuring our unrivalled  
25-year warranty.



# linea quattro

Exceed your shower expectations with Linea Quattro™

The premium tile-over channel drain shower solution for timber or concrete floors. Create a seamless bathroom with the level entry shower.

The Linea Quattro™ shower system is designed to be completely tiled, or used with wall linings like an acrylic wall liner.

- Low profile one piece shower base with an EasyClean Waste. May be installed as level entry or low step.
- 25-year leak-free warranty on Linea Quattro™ shower base
- Integrated channel drain in side or back configurations adjacent to wall. Tile-over drain cover supplied.
- Single tiling plane suits large format tiles, and reduces need for cutting fall in tiles.
- Available with 2140mm high frameless hinging, sliding or fixed panel (walk-in) screens including factory-applied CristalVision nano-coating.
- Optional EasyNiche™ Recessed Product Shelves (Pg. 16)
- 15 standard shower sizes and shapes available.





Linea Quattro™ level entry walk-in shower with Fixed Panel







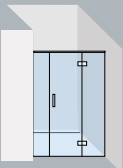
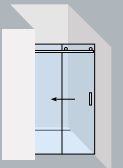
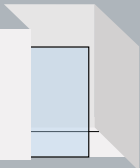

Top of class hardware finishes



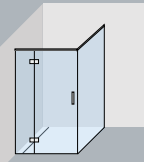
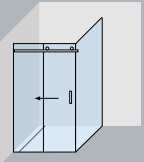
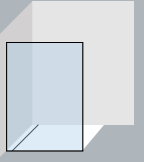

## Linea Quattro™ - hinged door, sliding door & walk-in shower sizes

| 3-WALLED SHOWERS   |           | 900MM & 1000MM DEEP |       |            |                       |  |   |   |  |
|--|-----------|---------------------|-------|------------|-----------------------|--|---|---|--|
| <br>BACK DRAIN POSITION | NAME      | SIZE (mm)           |       | BACK DRAIN | 2140mm HIGH FRAMELESS |  |  |  |  |
|  |           | WIDTH               | DEPTH |            |                       | ENCLOSED HINGED DOOR <b>HR</b>   | ENCLOSED SLIDING DOOR <b>SL3</b>  | WALK-IN FIXED PANEL <b>FX</b>   |  |
|  | MADRID    | 1000 x 1000         |       | •          |                       | •  |   |   |  |
|  | BERLIN    | 1200 x 900          |       | •          |                       | •  | •   | •   |  |
|  | TORONTO   | 1200 x 1000         |       | •          |                       | •  | •   | •   |  |
|  | BARCELONA | 1500 x 900          |       | •          |                       | •  | •   | •   |  |
|  | SEATTLE   | 1800 x 1000         |       | •          |                       | •  | •   | •   |  |

All 3-wall doors can be hinged or fixed from left or right wall. All 3-wall doors can slide from left to right or right to left.  

| 2-WALLED SHOWERS  |           | 900MM & 1000MM DEEP |   | LH DRAIN | RH DRAIN | 2140mm HIGH FRAMELESS |  |  |  |
|---|-----------|---------------------|---|----------|----------|-----------------------|--|---|---|
|   | NAME      | SIZE (mm)           |   |          |          |                       |  |   |   |
|   |           | WIDTH               | DEPTH   |          |          |                       |  |   |   |
| <br>LH DRAIN POSITION  |           |                     |   |          |          |                       |  |   |   |
| <br>RH DRAIN POSITION |           |                     |   |          |          |                       |  |   |   |
|   | DUBLIN    | 900 x 900           |     | •        | •        |                       | •  |   |   |
|   | MIAMI     | 1000 x 1000         |   | •        | •        |                       | •  |   |   |
|   | MILAN     | 1200 x 900          |   | •        | •        |                       | •  | •   | •   |
|   | SHANGHAI  | 1200 x 1000         |   | •        | •        |                       | •  | •   | •   |
|   | VANCOUVER | 1400 x 1000         |   | •        | •        |                       | •  | •   | •   |

Screens indicated are reversible.  



2 wall step entry two wall shower with sliding door



Linea Quattro Polished  
Stainless Steel Sliding Handle







# EasyNiche™

---

Explore EasyNiche™ —  
the simple and bulletproof  
shower niche solution.



# EasyNiche™

Enhance your shower with a selection of tile-over, exposed or retro-fitted recessed product shelves and footrests.

## Tile-over EasyNiche™

The tile-over EasyNiche™ is made to last for the life of your tile shower. A one-piece standalone unit, EasyNiche™ is 100% waterproof and comes with a 25-year warranty against leaks. Available in 10 convenient shelf sizes and a matching footrest. EasyNiche™ can be installed with any compliant waterproofing (using the simple self-adhesive connection tape supplied – see steps on next page). EasyNiche™ comes in a complete kit with installation materials included, and is designed to be tiled over.

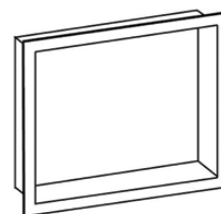
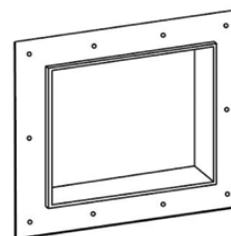
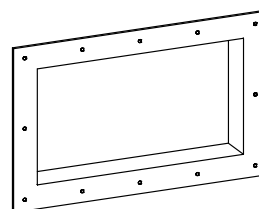

## Exposed/Tile-in EasyNiche™

The stylish exposed/tile-in EasyNiche™ is prefinished in white gloss and is recessed into tiled walls before tiling. Simply tile up to the lip. Solid one-piece construction, 100% waterproof and includes a 7-year durability warranty. All installation materials are supplied.

## Retrofit EasyNiche™

Create space in your shower with a non-tiled recessed EasyNiche™ available in gloss white finish. Simply retro-fit into a wall liner, and enjoy the functional and elegant finish of a Retrofit EasyNiche™. Solid one-piece construction, 100% waterproof and includes a 7-year durability warranty. All installation materials are supplied.

EasyNiche Registered Design No. 415619, 415620, 418228. Towel Warmer Patent No. 626027.



Tile-over



Exposed/Tile-in

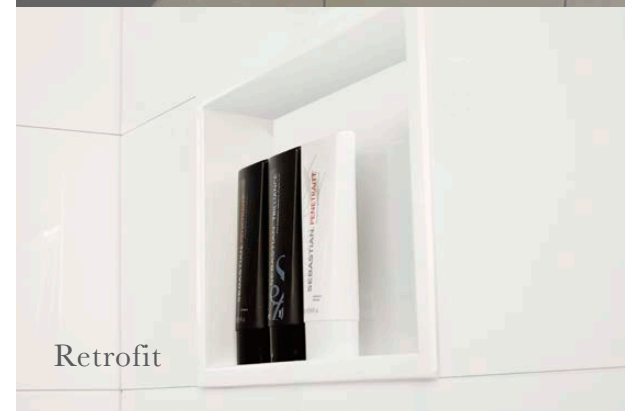

Retrofit



# Tile-over EasyNiche™ - shelf sizes, specifications & installation overview

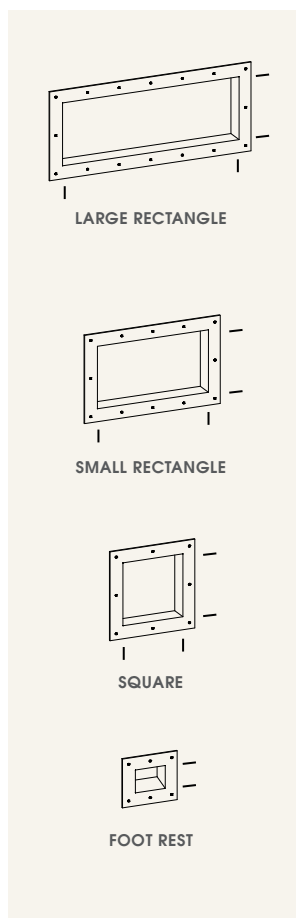

## LARGE RECTANGLE

| OVERALL TILE LENGTH | RECESS SIZE (mm) | CODE   |
|---------------------|------------------|--------|
| 1500mm              | 1540 x 340       | EN1500 |
| 1200mm              | 1240 x 340       | EN1200 |
| 900mm               | 940 x 340        | EN900  |
| 750mm               | 790 x 340        | EN750  |

## SMALL RECTANGLE

| OVERALL TILE LENGTH | RECESS SIZE (mm) | CODE  |
|---------------------|------------------|-------|
| 600mm               | 640 x 340        | EN600 |
| 500mm               | 540 x 340        | EN500 |
| 450mm               | 490 x 340        | EN450 |
| 350mm               | 390 x 340        | EN350 |
| 200mm               | 240 x 340        | EN200 |

## SQUARE

| OVERALL TILE LENGTH | RECESS SIZE (mm) | CODE  |
|---------------------|------------------|-------|
| 300mm               | 340 x 340        | EN300 |

## FOOT REST

| OVERALL TILE LENGTH | RECESS SIZE (mm) | CODE   |
|---------------------|------------------|--------|
| 140mm               | 180 x 120        | EN140F |

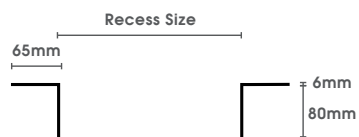

For ceramic tiled walls.

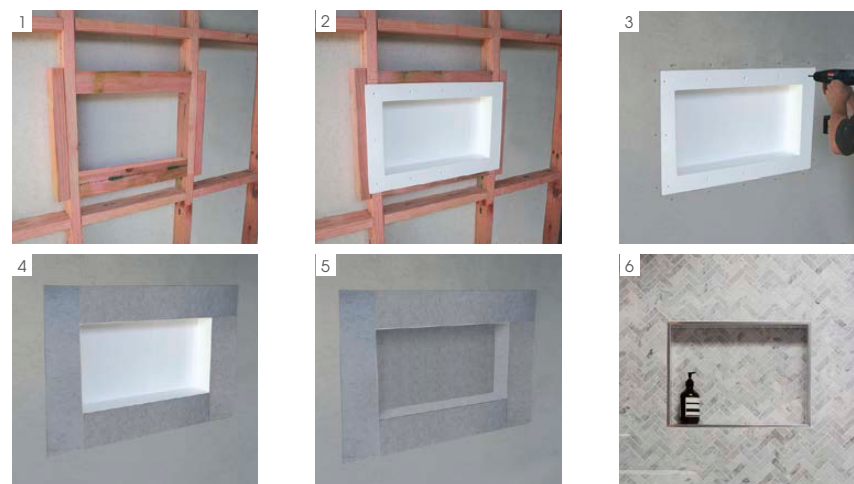

Overview Only. See installation instructions for full method.



For a more in-depth look, please view our instructional video at [atlantis.com.au](https://atlantis.com.au)

- Solid one-piece lightweight construction made from waterproof HIPS composite.
- 100% waterproof.
- Immediately ready-to-tile (once interlayer is applied).
- Built-in gradient prevents water ponding.
- Compliant with AU Building Code.
- Fits into 90mm wall cavity.
- 65mm waterproofing flange.
- Suitable for horizontal or vertical installation (except footrest).
- Suitable for all wallboards (recommended 6mm minimum).
- Supplied with self-adhesive reinforcement band for connection to wallboard and waterproofing.
- Must be installed prior to wallboard, and requires additional framing for correct setup.
- Supplied with installation materials.
- 25-year durability and leak-free warranty.

## Exposed/Tile-in EasyNiche™ - shelf sizes, specifications & installation overview

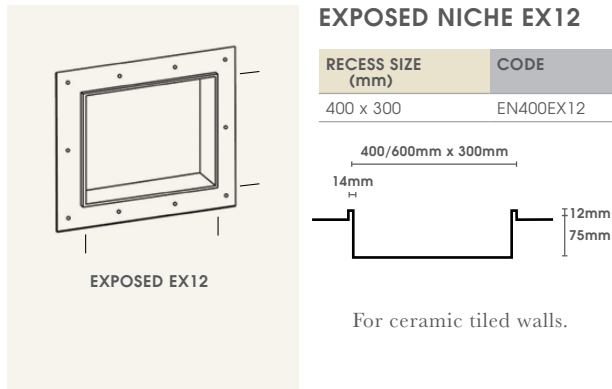

- One-piece lightweight construction made from rigid PMMA.
- Gloss white surface.
- Available in one size 400mm x 300mm.
- Suits tiles up to 12mm thick.
- Built in gradient prevents water ponding.
- 65mm waterproofing flange.
- Must be installed prior to wallboard and requires additional framing.
- Supplied with installation materials.
- 7-year warranty.

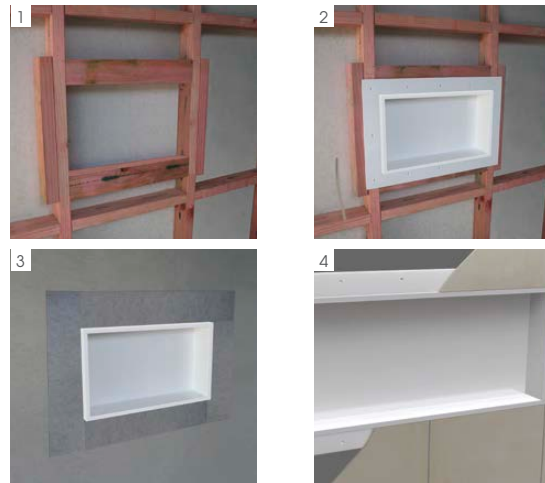

**Overview Only. See installation instructions for full method.**



For a more in-depth look, please view our instructional video at [atlantis.com.au](http://atlantis.com.au)

## Retrofit EasyNiche™ - shelf sizes, specifications & installation overview



### RETRO-FIT NICHE

| OPTION                | CODE      |
|-----------------------|-----------|
| 400 x 300 Gloss White | EN400RF-W |

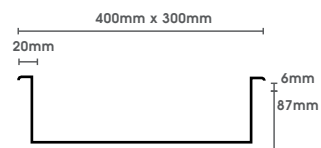

For acrylic wall liner.



### RETRO-FIT FOOTREST

| OPTION                | CODE        |
|-----------------------|-------------|
| 165 x 225 Gloss White | EN140F-RF-W |

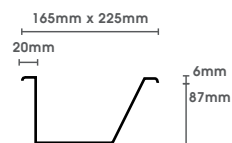

For acrylic wall liner.

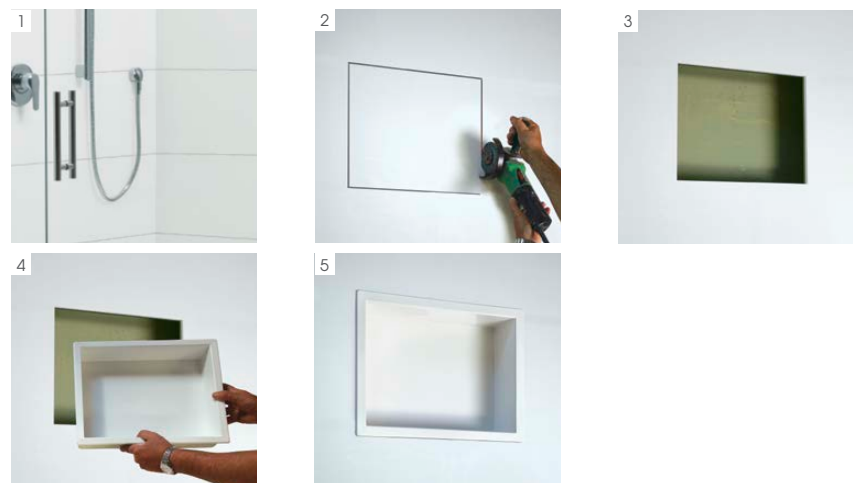

**Overview Only. See installation instructions for full method.**



For a more in-depth look, please view our instructional video at [atlantis.com.au](https://atlantis.com.au)

- One-piece lightweight construction made from rigid PMMA in Gloss White.
- Available in two sizes – Product Niche 400mm x 300mm or Footrest 165mm x 225mm overall
- Designed to be installed in ‘existing’ shower wall/liner.
- Protrudes 6mm from wall surface finish.
- Product Niche can be installed horizontally or vertically.
- Built in gradient prevents water ponding.
- Supplied with installation materials.
- 7-year warranty.



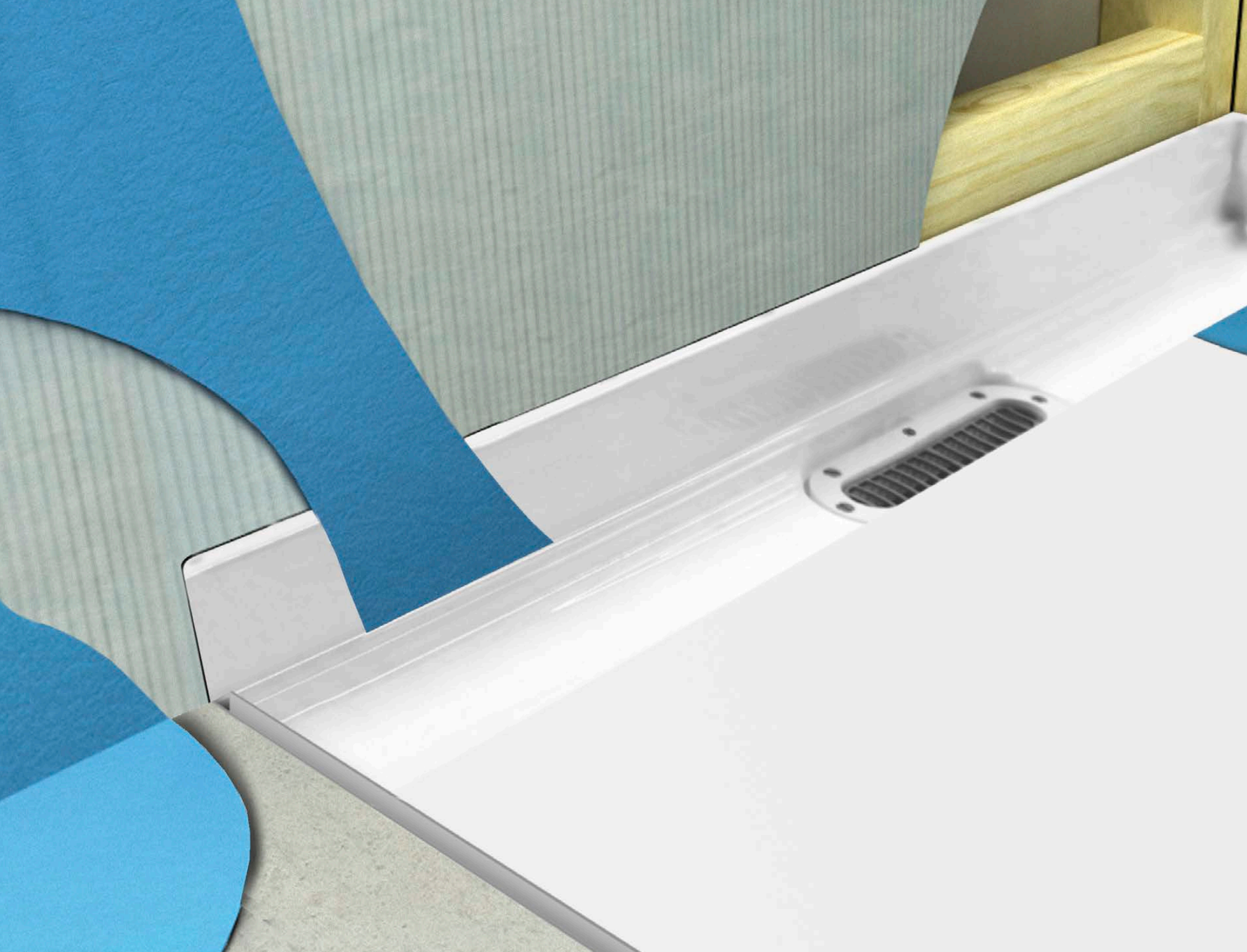

A large, abstract, light blue curved shape, resembling a stylized 'C' or a wing, is positioned on the left side of the slide. It is set against a white background that also features a yellow rectangular shape in the upper left corner.

# Technical

---

Get to know our products  
inside and out with our  
technical guides and  
specifications

# Atlantis Product Warranties

Atlantis Bathroom Style Pty Ltd (“the company”) warrants that products or product components manufactured and distributed by the company:

- Meet or exceed the standard requirements of the Building Code of Australia; and
- Will be free from inherent defects in materials and workmanship for the extended warranty period applicable to the Product (see below).



## 25 LEAK FREE DURABILITY WARRANTY

- Linea Quattro™ Base
- EasyNiche™ Tile-over



## 7 YEAR WARRANTY

- EasyNiche™ Exposed
- EasyNiche™ Retro-Fit



## 5 YEAR WARRANTY

- Atlantis Toughened Glass\*

### LEAK-FREE WARRANTY

When the shower components are installed in accordance with the manufacturer’s instructions, Atlantis Bathroom Style Pty Ltd warrants that the tile-over shower base will not allow water leakage\* into the building structure for a minimum period of 25 years.

\*Water leakage excludes surface splashes.

The liability of the company is limited to the replacement of products (or system components) for an equivalent product, and the installation thereof provided the product or component is declared defective by an authorised representative of the company.

The company will not be liable for any damages or losses beyond the installation of replacement products as originally supplied. Under no circumstances will the company be liable for consequential or incidental damages related to the use of this product.

**DO NOT** install a damaged or defective product. Use only the primers, adhesives and silicon sealants supplied with this product, as directed, for the installation of this product.

Apply an approved waterproofing membrane, to the walls. Use only the recommended tile adhesives compatible with selected membrane. Failure to comply may deem this warranty void.

This warranty will not apply where the Products have been improperly installed, have been misused or proof of purchase cannot be provided. The leak-free warranty may not apply where the warranty claim has not been notified to the company within 90 days of the problem first appearing or where any system component is substituted without the company’s express agreement.

### INSTALLATION WARRANTY

As offered by your independent contractor/installer. The installer should offer a minimum 5-year installation guarantee for workmanship. Please check before proceeding with any part of this installation.

Please note: Atlantis product warranties apply regardless of who installs the product. Installation warranty not offered by Atlantis. For full details and terms and conditions of warranty please refer to our website – [www.atlantis.com.au/warranty](http://www.atlantis.com.au/warranty)

\*T&Cs apply to Glass Warranty. please refer to our website for details.

**Note: Atlantis reserves the right to change product specifications without notice to other parties.**



## Essential Structure

Atlantis shower bases are unlike any other. Already waterproof, the one-piece preformed base is designed for perfect water drainage, leaving no chance for water to escape other than where directed. The Linea Quattro™ shower base essential structure is shown in the diagram below.

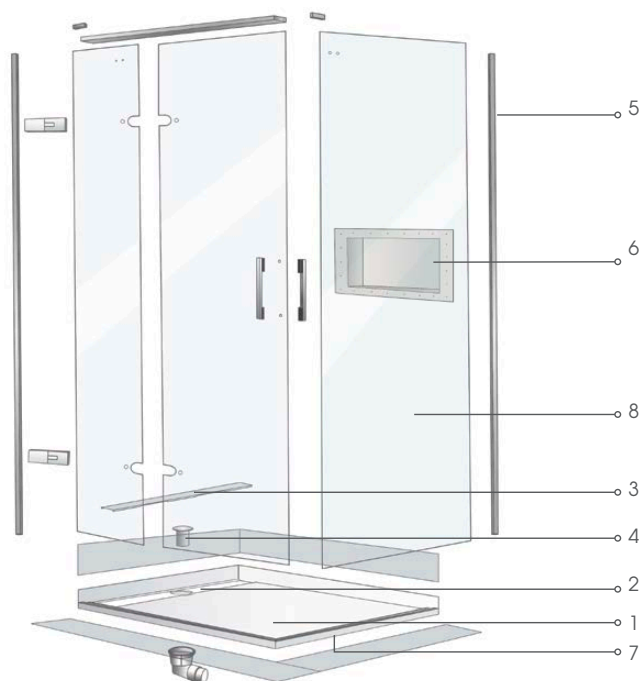

- |                                     |  |
|-------------------------------------|--|
| 1. One piece shower base            | 5. Wall glazing channels                     |
| 2. Channel drain                    | 6. (Optional) EasyNiche™ accessory           |
| 3. Stainless steel drain cover      | 7. Base glazing channels (factory installed) |
| 4. Waste outlet – 40/50mm EasyClean | 8. Screens.                                  |

## Waterproofing

The 100% waterproof Atlantis shower base and connection tapes are compliant with the requirements of the Building Code of Australia. The shower system is compatible with any compliant waterproofing membrane used on the walls and for the rest of the bathroom floor.

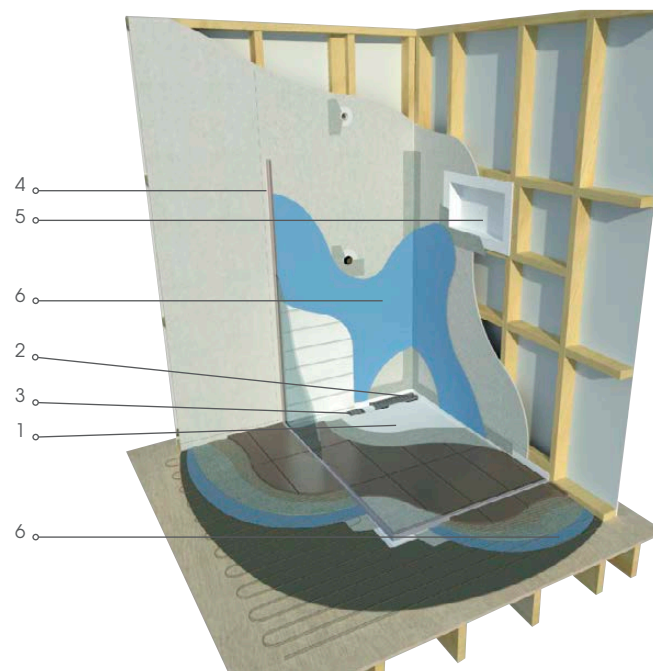

- |  |                                      |
|--|--------------------------------------|
| 1. One piece shower base                   | 4. Glazing channels                  |
| 2. Channel drain and stainless steel grate | 5. EasyNiche™ accessory              |
| 3. EasyClean waste                         | 6. Liquid waterproofing (by others). |

# Linea Quattro™ shower system specifications

## SHOWER BASE

- Structurally solid one-piece preformed fibreglass base, already 100% waterproof.
- May be installed to achieve a stepless shower floor or simply placed on an existing floor for low step entry.
- 100mm high upstand from floor – for secure connection to wall membrane.
- Factory-fitted glass receiver channels on base.
- Guaranteed fall (1:80) to waste.
- Single plane to channel drain surface accepts tiles up to 12mm thick (standard).
- Weight: 16kg/m².

## CHANNEL DRAIN & WASTE

- Integral channel drain located at side/back.
- 40/50mm EasyClean trap.
- Minimum flow rate 40 litres per minute.
- Stainless Steel drain cover.

## PRECISION-FIT NAKED FRAMELESS SCREENS

- 8mm toughened safety glass.
- CristalCote nano-coating factory-applied.
- Hinged door option complete with chrome/stainless steel handles, solid brass hinges and fixing materials.

- Sliding door option complete with stainless steel handles, roller assemblies and installation materials.
- Walk-in fixed panel options available in most sizes.
- Satin anodised wall glass receiver channels incorporate mechanical glass locking system and are machined to lock with base channels.
- High strength chrome top rail brace at 2000mm high above base.
- Screens supplied at 2120mm overall height.

## WATERPROOFING

- Optional-Essential Connection Waterproofing Tapes available for the secure connection of the wallboard to the base upstand and from the base perimeter to the floor. Included with this optional package is a base adhesion layer.
- Compatible with all compliant liquid waterproofing products.

## INSTALLATION

Atlantis recommends installation of Linea Quattro™ showers is undertaken by an experienced tradesperson.



Illustration of 2-walled Linea Quattro™ shower showing sliding door.



## BASE PROFILE STEP ENTRY ON ANY FLOOR STRUCTURE

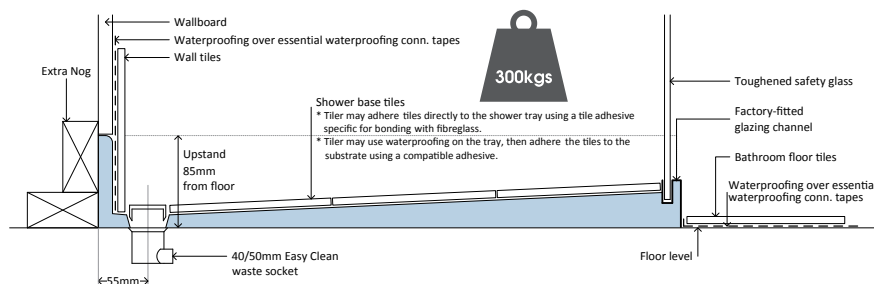

## BASE PROFILE LEVEL ACCESS IN A TIMBER FLOOR

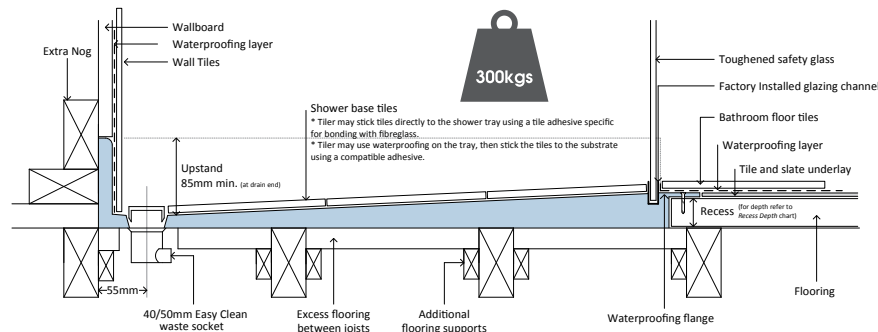

Specifications subject to change without notice. Please check [www.atlantis.com.au](http://www.atlantis.com.au) for latest version.

# Linea Quattro™ order form

|           |  |          |  |
|-----------|--|----------|--|
| Date:     |  | Order #: |  |
| Merchant: |  | Contact: |  |

## 3-WALLED SHOWERS

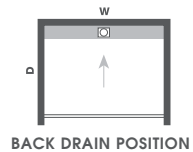

BACK DRAIN POSITION

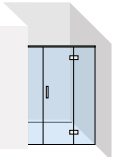
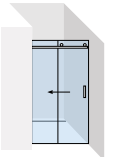
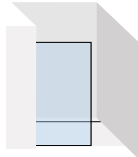
| NAME         | SIZE (mm)   | BACK DRAIN               |  | 2140mm HIGH FRAMELESS    |  |  |  |
|--------------|-------------|--------------------------|---|--------------------------|--|---|---|
|              |             |                          |   |                          | ENCLOSED HINGED DOOR <b>HR</b>   | ENCLOSED SLIDING DOOR <b>SL</b>   | WALK-IN FIXED PANEL <b>FX</b>   |
| BASE PACKAGE |             |                          |   | BASE AND SCREENS PACKAGE |  |   |   |
|              | WIDTH       |                          | CODE  |                          | CODE   |   | CODE  |
| MADRID       | 1000 x 1000 | <input type="checkbox"/> | LQ-MAD  | <input type="checkbox"/> | MAD-HR   | <input type="checkbox"/>  |   |
| BERLIN       | 1200 x 900  | <input type="checkbox"/> | LQ-BER  | <input type="checkbox"/> | BER-HR   | <input type="checkbox"/>  | BER-SL <input type="checkbox"/>   |
| TORONTO      | 1200 x 1000 | <input type="checkbox"/> | LQ-TOR  | <input type="checkbox"/> | TOR-HR   | <input type="checkbox"/>  | TOR-SL <input type="checkbox"/>   |
| BARCELONA    | 1500 x 900  | <input type="checkbox"/> | LQ-BAR  | <input type="checkbox"/> | BAR-HR   | <input type="checkbox"/>  | BAR-SL <input type="checkbox"/>   |
| SEATTLE      | 1800 x 1000 | <input type="checkbox"/> | LQ-SEA  | <input type="checkbox"/> | SEA-HR   | <input type="checkbox"/>  | SEA-SL <input type="checkbox"/>   |
|              |             |                          |   |                          |  |   | BER-FX <input type="checkbox"/>   |
|              |             |                          |   |                          |  |   | TOR-HR <input type="checkbox"/>   |
|              |             |                          |   |                          |  |   | BAR-FX <input type="checkbox"/>   |
|              |             |                          |   |                          |  |   | SEA-FX <input type="checkbox"/>   |

All 3-wall doors can be hinged or fixed from left or right wall. ☐ ☐

## 2-WALLED SHOWERS

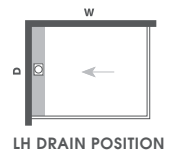

LH DRAIN POSITION

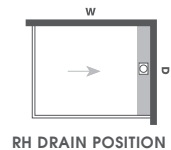

RH DRAIN POSITION

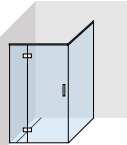
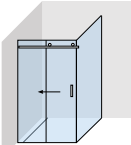
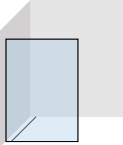
| NAME         | SIZE (mm)   | LH DRAIN                 |                          | RH DRAIN |                          |  | 2140mm HIGH FRAMELESS    |  | ENCLOSED HINGED DOOR <b>HR-B</b> |  | ENCLOSED SLIDING DOOR <b>SL</b> |  | WALK-IN FIXED PANEL <b>FX</b> |                          |
|--------------|-------------|--------------------------|--------------------------|----------|--------------------------|---|--------------------------|---|----------------------------------|--|---------------------------------|--|-------------------------------|--------------------------|
|              |             |                          |                          |          |                          |   |                          |   |                                  |  |                                 |  |                               |                          |
| BASE PACKAGE |             |                          |                          |          |                          |   | BASE AND SCREENS PACKAGE |   |                                  |  |                                 |  |                               |                          |
|              | WIDTH       |                          |                          | CODE     |                          |   | CODE                     |   |                                  | CODE   |                                 |  | CODE                          |                          |
| DUBLIN       | 900 x 900   | <input type="checkbox"/> | <input type="checkbox"/> | LQ-DUB   | <input type="checkbox"/> |   | DUB-HR-B                 | <input type="checkbox"/>  |                                  |  |                                 |  |                               |                          |
| MIAMI        | 1000 x 1000 | <input type="checkbox"/> | <input type="checkbox"/> | LQ-MIA   | <input type="checkbox"/> |   | MIA-HR-B                 | <input type="checkbox"/>  |                                  |  |                                 |  |                               |                          |
| MILAN        | 1200 x 900  | <input type="checkbox"/> | <input type="checkbox"/> | LQ-MIL   | <input type="checkbox"/> |   | MIL-HR-B                 | <input type="checkbox"/>  |                                  | MIL-SL   | <input type="checkbox"/>        |  | MIL-FX                        | <input type="checkbox"/> |
| SHANGHAI     | 1200 x 1000 | <input type="checkbox"/> | <input type="checkbox"/> | LQ-SHA   | <input type="checkbox"/> |   | SHA-HR-B                 | <input type="checkbox"/>  |                                  | SHA-SL   | <input type="checkbox"/>        |  | SHA-FX                        | <input type="checkbox"/> |
| VANCOUVER    | 1400 x 1000 | <input type="checkbox"/> | <input type="checkbox"/> | LQ-VAN   | <input type="checkbox"/> |   | VAN-HR-B                 | <input type="checkbox"/>  |                                  | VAN-SL   | <input type="checkbox"/>        |  | VAN-FX                        | <input type="checkbox"/> |

A Base Package includes a tileover base with a channel drain, drain cover and waste.

## EasyNiche™

**OPTIONAL ACCESSORIES**  
(additional charge applies)

Suitable for Tiled Walls

|             |                          |
|-------------|--------------------------|
| EN1500      | <input type="checkbox"/> |
| EN1200      | <input type="checkbox"/> |
| EN900       | <input type="checkbox"/> |
| EN750       | <input type="checkbox"/> |
| EN600       | <input type="checkbox"/> |
| EN500       | <input type="checkbox"/> |
| EN450       | <input type="checkbox"/> |
| EN350       | <input type="checkbox"/> |
| EN300       | <input type="checkbox"/> |
| EN200       | <input type="checkbox"/> |
| EN140F      | <input type="checkbox"/> |
| EN400EX12-W | <input type="checkbox"/> |





# About Atlantis

---

An evolution in bathroom style and functionality.

Atlantis invented the EasyTile™ shower system in 1996, and have continued to develop innovative bathroom solutions since. Atlantis Showers have been enjoyed throughout Australasia for the past 20 years.

Atlantis is a family owned and operated company, distributing bathroom products throughout Australia and New Zealand.

We like taking things apart, rethinking them, exploring new possibilities, developing new standards of efficiency, making things more robust, better suited to purpose. In short, we like inventing things that work better than all other comparisons.

Beautiful to look at. Fabulous to live with. Astonishingly easy to install. Leak-free for life.

For more information on all of our products and product ranges, visit our website, [www.atlantis.com.au](http://www.atlantis.com.au) or call us on 1800 786 297.



# Online Product Selector

Simplify your experience with Atlantis. Visit our website for a simple walk-through of all Atlantis products. Search and filter our ranges, make a list and then easily send it to your nearest retailer(s) to request a quote.

Visit [atlantis.com.au/selector](http://atlantis.com.au/selector) for more information.

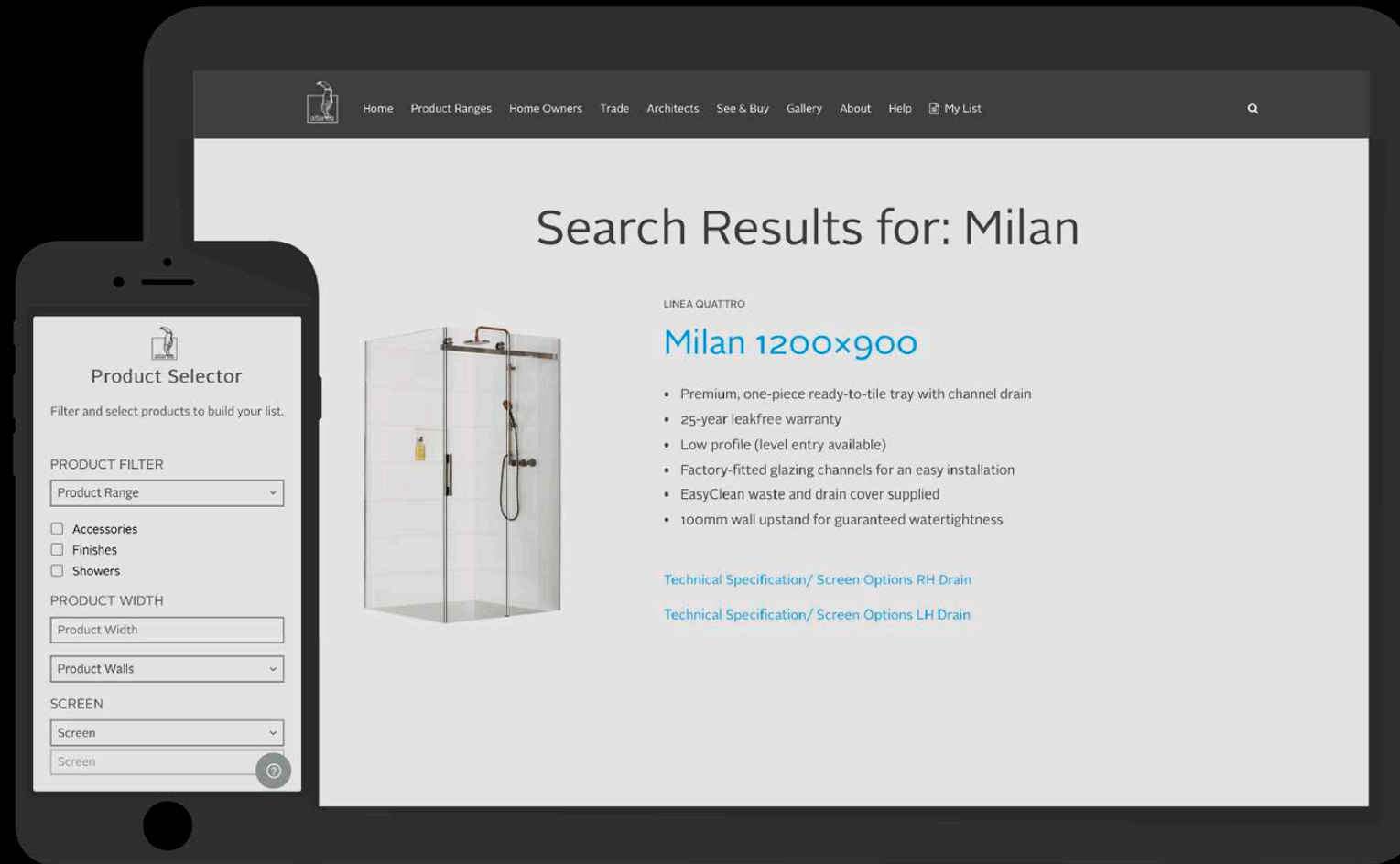

AU Edition 1