

EASYNICHE TILE-OVER SQUARE

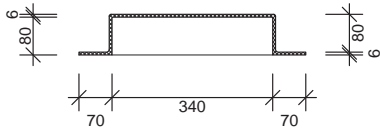

Section

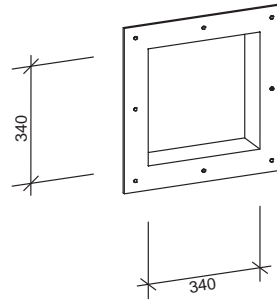

Perspective

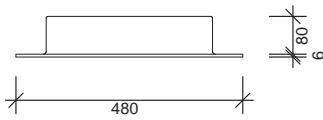

Plan

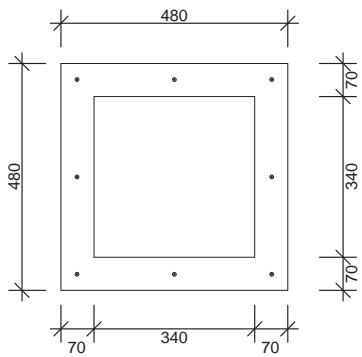

Front Elevation

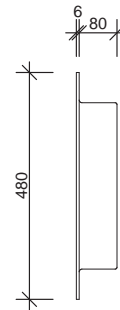

Side Elevation

EASYNICHE TILE-OVER SMALL RECTANGLE

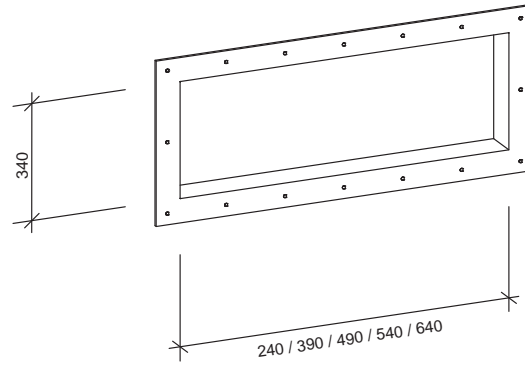

Perspective

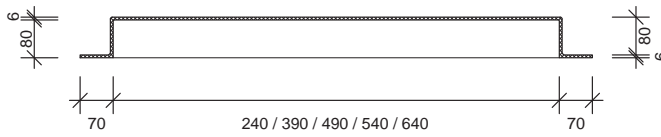

Section

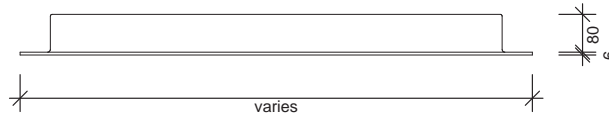

Plan

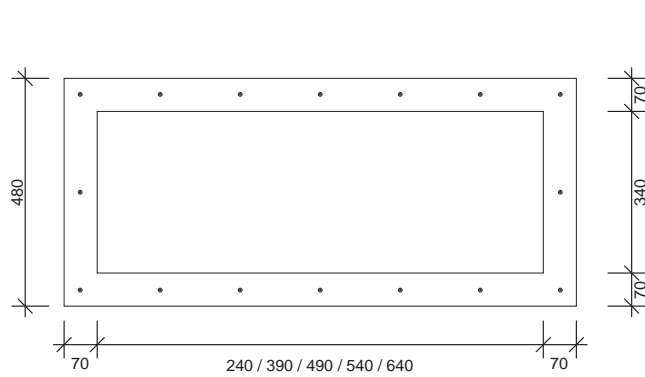

Front Elevation

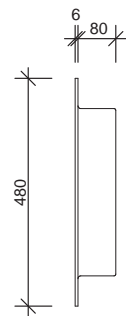

Side Elevation

EASYNICHE TILE-OVER LARGE RECTANGLE

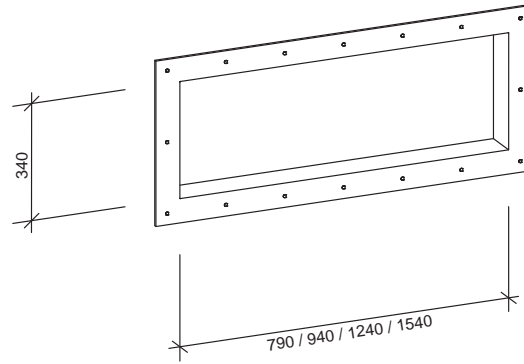

Perspective

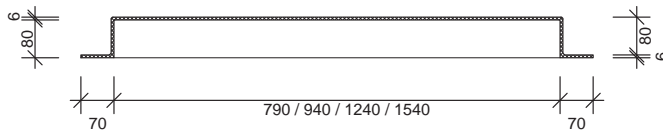

Section

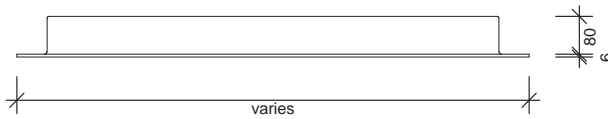

Plan

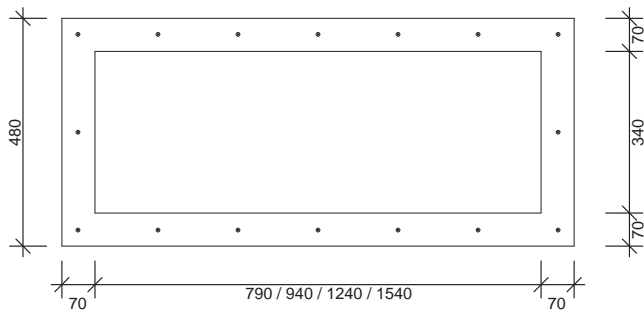

Front Elevation

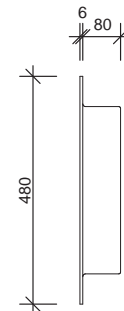

Side Elevation

EASYNICHE TILE-OVER FOOTREST

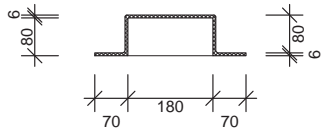

Section

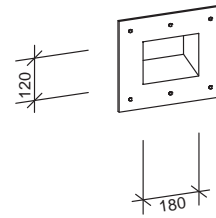

Perspective

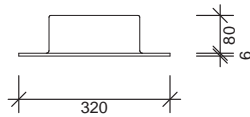

Plan

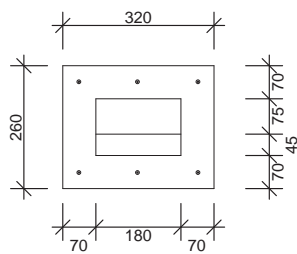

Front Elevation

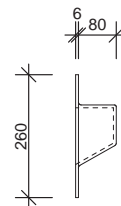

Side Elevation

EASYNICHE

EXPOSED 12mm

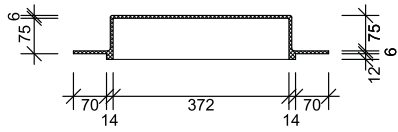

Section

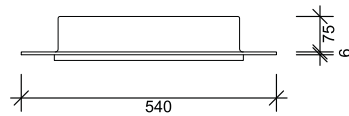

Plan

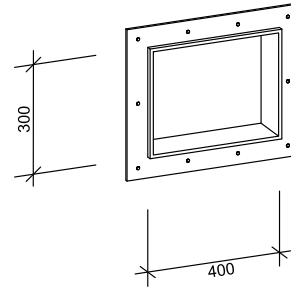

Perspective

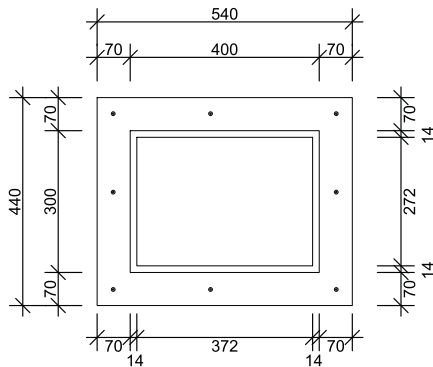

Front Elevation

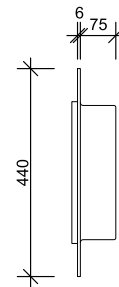

Side Elevation

SPECIFICATION

- One-piece lightweight construction made from rigid GRP composite.
- Gloss gel coat surface available in white finish.
- Available in one size 400mm x 300mm.
- Must be installed prior to wallboard and requires additional framing.
- Supplied with installation materials.
- 7-year warranty
- To suit 8mm to 12mm tiles.



INSTALLATION STEPS:



Overview only.

EASYNICHE RETROFIT

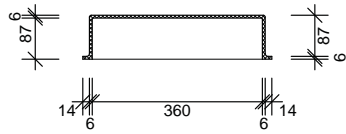

Section

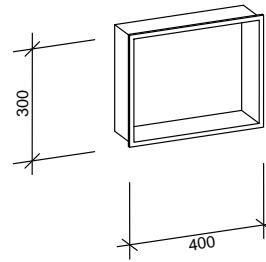

Perspective

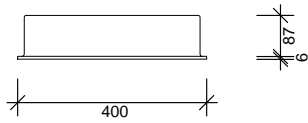

Plan

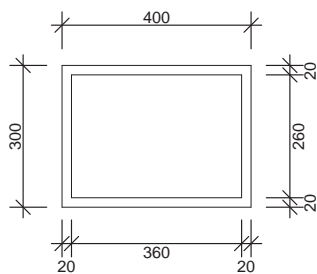

Front Elevation

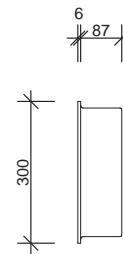

Side Elevation

INSTALLATION STEPS:



Overview only. See installation instructions for correct method.

SPECIFICATION

- One-piece lightweight construction made from rigid GRP composite.
- Gloss gel coat surface available in white finish only.
- Available in one size 400mm x 300mm.
- Designed to be installed to existing shower, tiles, acrylic liner or laminates.
- Protrudes 6mm from wall surface finish.
- Can be installed horizontally or vertically.
- Built in gradient prevents water ponding.
- Supplied with installation materials.
- 7-year warranty.

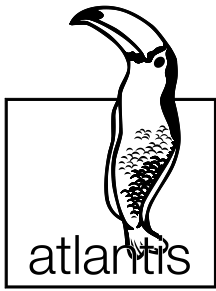

atlantis Wet Area Systems

Shower / Bath - Easyniche

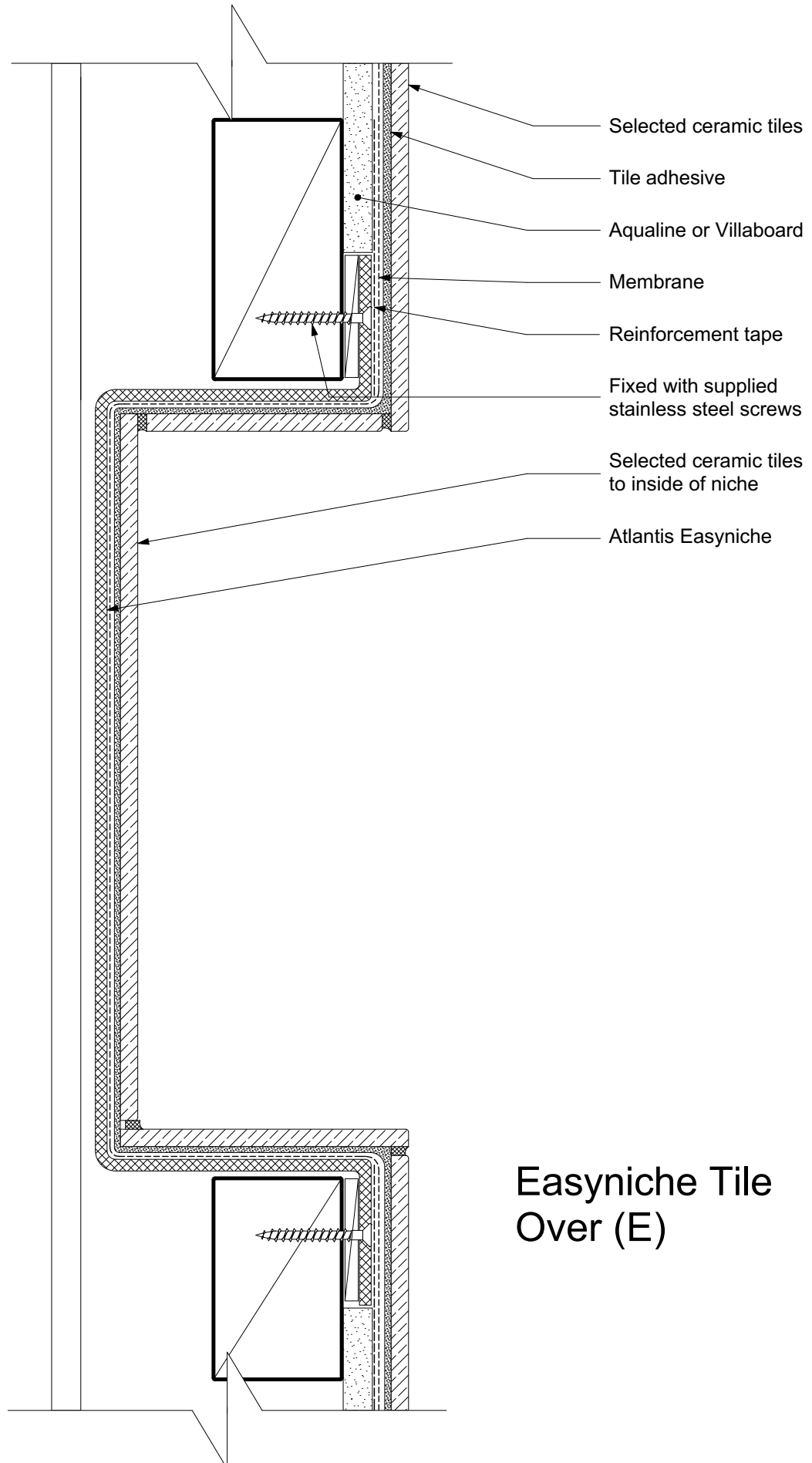

**Easyniche Tile
Over (E)**

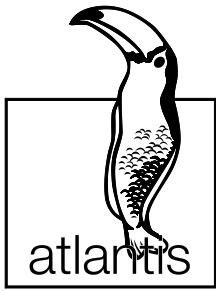

atlantis Wet Area Systems

Shower / Bath - Easyniche

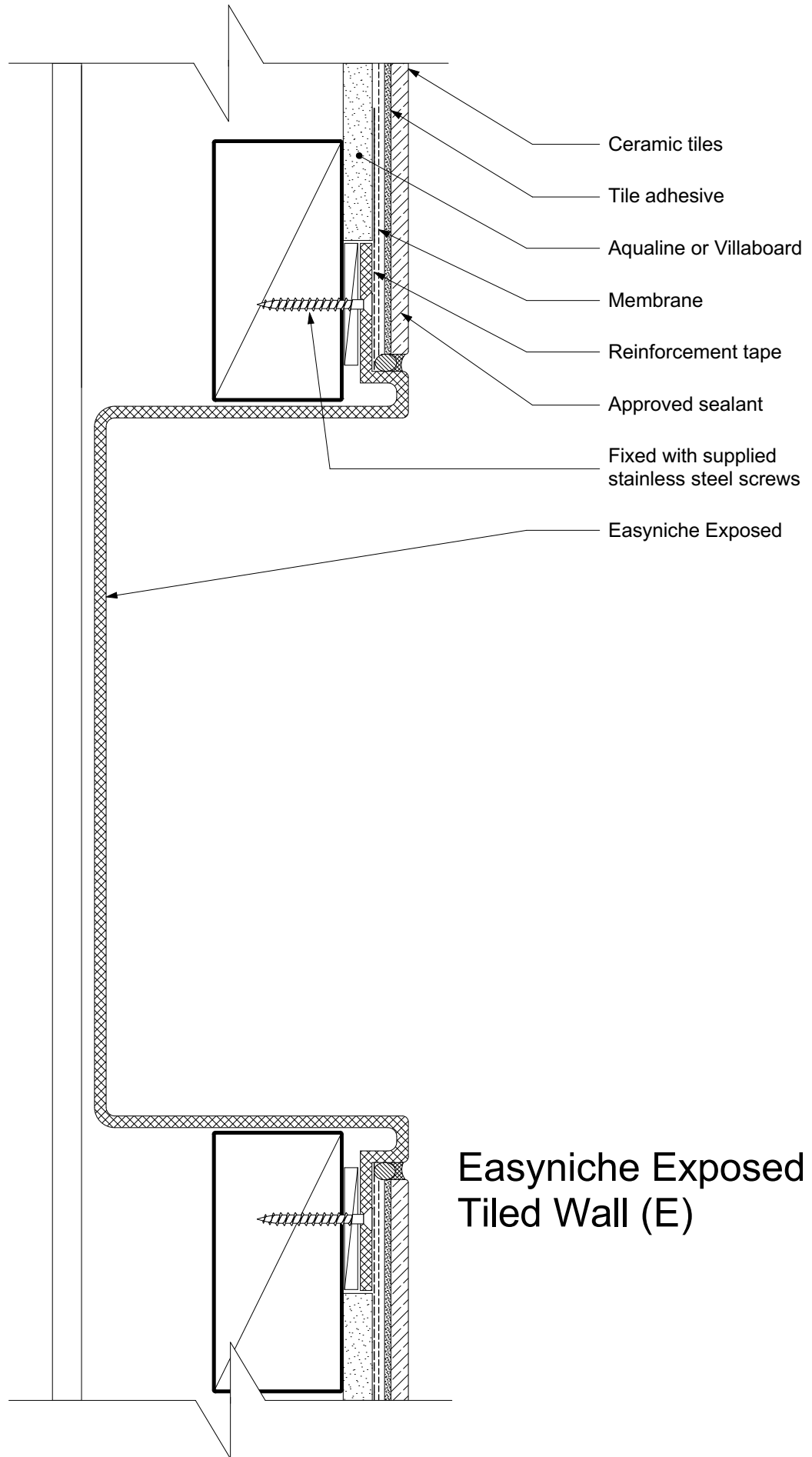



atlantis Wet Area Systems

Shower / Bath - Easyniche

